

Lab Seed Coating Machine

SD-8005

The universal batch coater is a meticulously designed machine tailored for the precise encrusting and pelleting of small batches, making it particularly well-suited for applications like seed breeding and testing. Its versatility extends to accommodating virtually all types of seeds and a wide range of seed treatment processes. One of the standout features of this system is its exceptional capability to provide uniform distribution of dressing, even when working with low dosing rates and significantly reduced mixing times. This ensures that the seeds receive a consistent and thorough treatment.

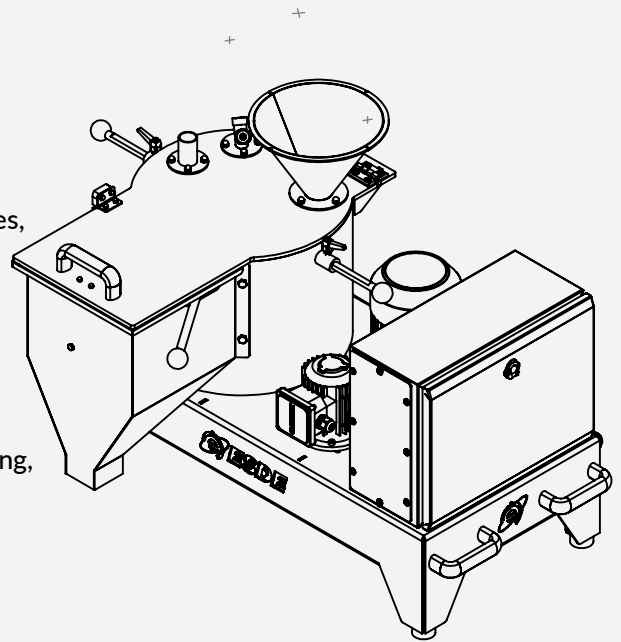

Furthermore:

The system is engineered with ease of maintenance and cleaning in mind, allowing for swift and efficient cleanup procedures, which is especially valuable in time-sensitive applications.

Rotary Coaters, such as this one, excel in delivering rapid and consistent seed treatment applications. This is achieved through the implementation of rotary technology in combination with advanced application methods, guaranteeing optimal seed distribution of pesticides and other plant protection products.



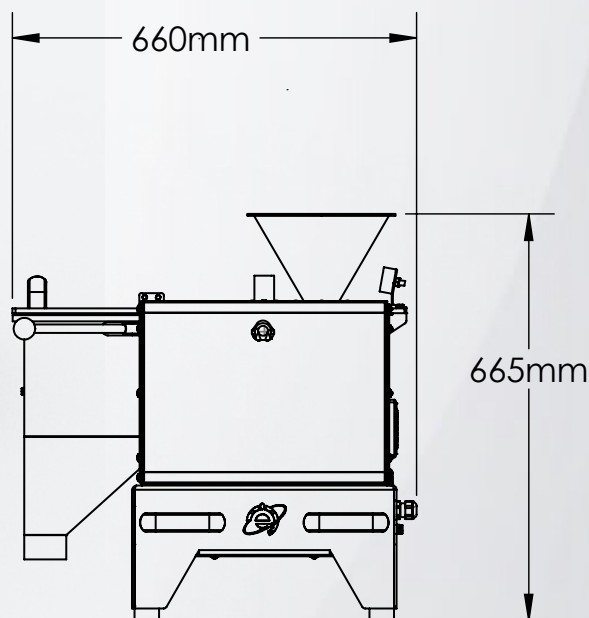
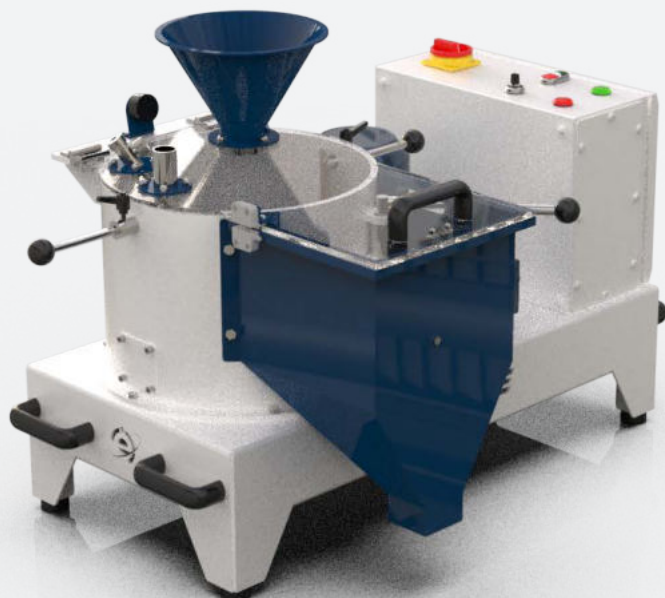

LAB SEEDCOATING MACHINE SD-8005

**Capacity:**

±100 – 1500 grams

Dimensions:

1065 x 660 x 665 mm (LxWxH)
Diameter coater 300 mm

Noise emission:

± 75 dB (A) (measured without product)

Electrical connection

200- 240 V (± 5%), 1 phases + 0 and ground,
50 / 60 Hz (other values available on request)
Max. power consumption: 0,75 kW
Connection value: 10 A

Connections:**Materials:**

Electrostatic paint on steel

Weight:

Net: ± 60 kg
With Packaging: ± 80 kg

**Including:****Options:**

Liquid dosing unit